









DO NOT SCALE FROM THIS DRAWING.  
 USE FIGURED DIMENSIONS ONLY.  
 ALL AREAS SHOWN ARE APPROXIMATE AND SITE  
 DIMENSION CHECKS SHOULD BE TAKEN.  
 THIS DRAWING IS TO BE READ IN CONJUNCTION WITH  
 ALL OTHER ARCHITECTS AND OTHER CONSULTANTS  
 DRAWINGS, DETAILS AND SPECIFICATIONS.  
 ANY DISCREPANCIES WITH THIS DRAWING SHOULD  
 BE REPORTED TO THE ARCHITECT IMMEDIATELY.

**NOTES**

Easements have been shown in  
 approximate locations & are subject to final  
 agreement by service authorities

	Denotes site boundary
	Denotes Cycle Link
	Phase 1 Selco Builders Warehouse
	Phase 2 Retail (approx. total 1,600 sq m)
	Phase 3 Trade Counter (approx. total 3,500-5000 sq ft)
	Phase 4 B1/B2/B8 Industrial Units (approx. total 750-2000 sq ft)
	Phase 5 B1/B2/B8 Design & Build Land
	Phase 6 B1/B2/B8 Design & Build Land

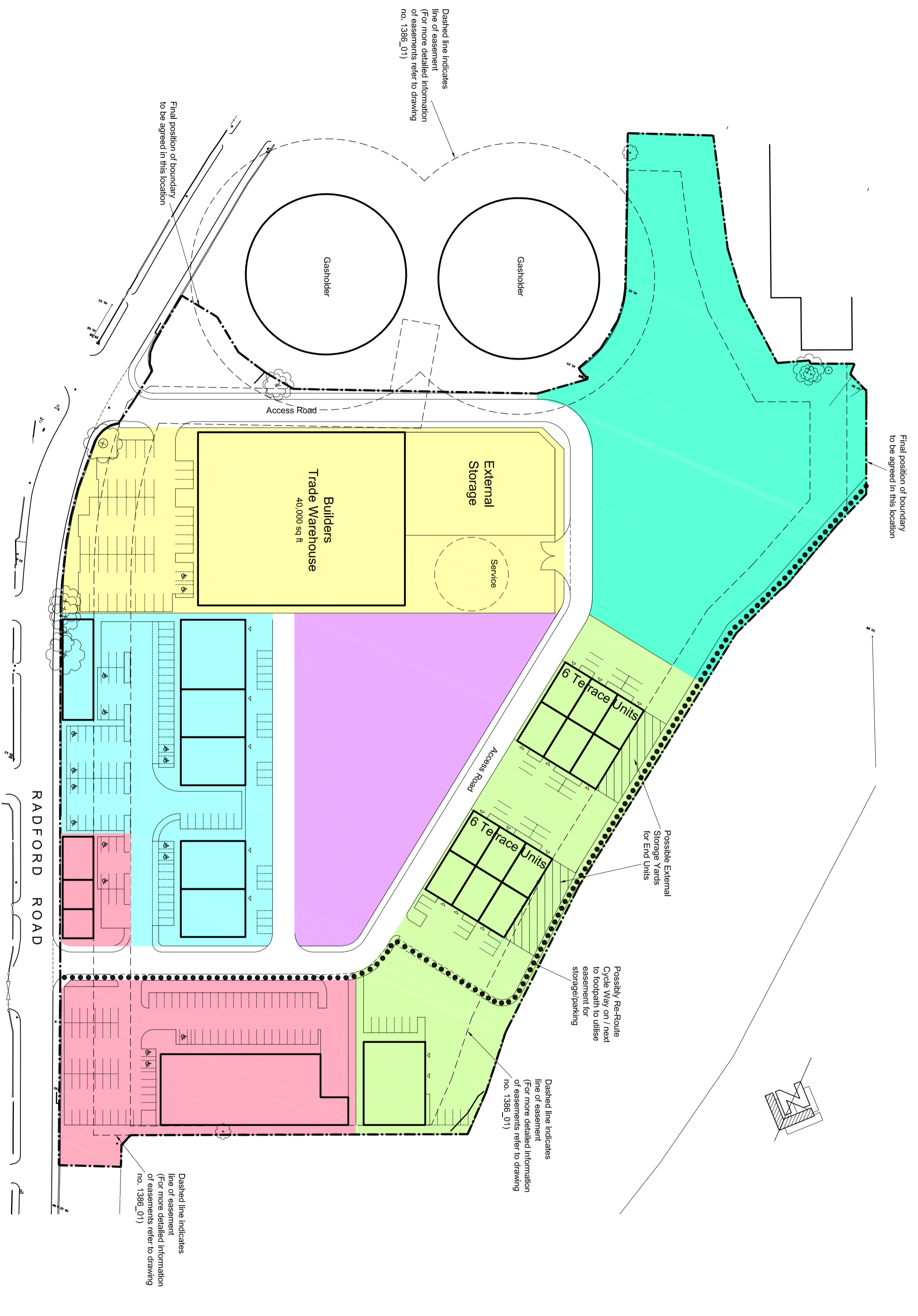

DRAWING STATUS

**DESIGN**

P4	TEXT & RETAIL AMENDED.	DR	26.11.07
P3	LAYOUT AMENDED & PHASING ADDED	DR	26.11.07
P2	LAYOUT OF UNITS CHANGED / ADDITIONAL	JH	13.11.07
NOTES			
P1	LAYOUT & EASEMENTS AMENDED	DR	08.11.07
P0	INITIAL ISSUE	DR	25.10.07
REV	AMENDMENTS	DRAWN	DATE
			AUTHD

CLIENT

**MARCITY DEVELOPMENTS LTD**

PROJECT

**DEVELOPMENT  
 RADFORD ROAD, NOTTINGHAM**

**architects**

Ludgate Plaza, 231 Ludgate Hill  
 Birmingham, B3 1DX  
 Tel 0121 212 1484 Fax 0121 212 1404  
 Email: info@architects.com

Architects Development Consultants  
 Project Managers Planning Supervisors

TITLE

**MASTER SITE PLAN  
 PRELIMINARY LAYOUT**

Project No.	1386	Scale	1:1000 @A2	DWG No.	02	Revision	P4
Date	OCT 2007	Client	XXXX				